

EXG. BUILDING IN GROUND FLOOR  
 AND FLOOR IN P.No. 323 IN APPD. No  
 B.A.No. 28/85 F<sub>2</sub> B.L.No. 34/85/F<sub>2</sub>  
 DT:- 12-2-85

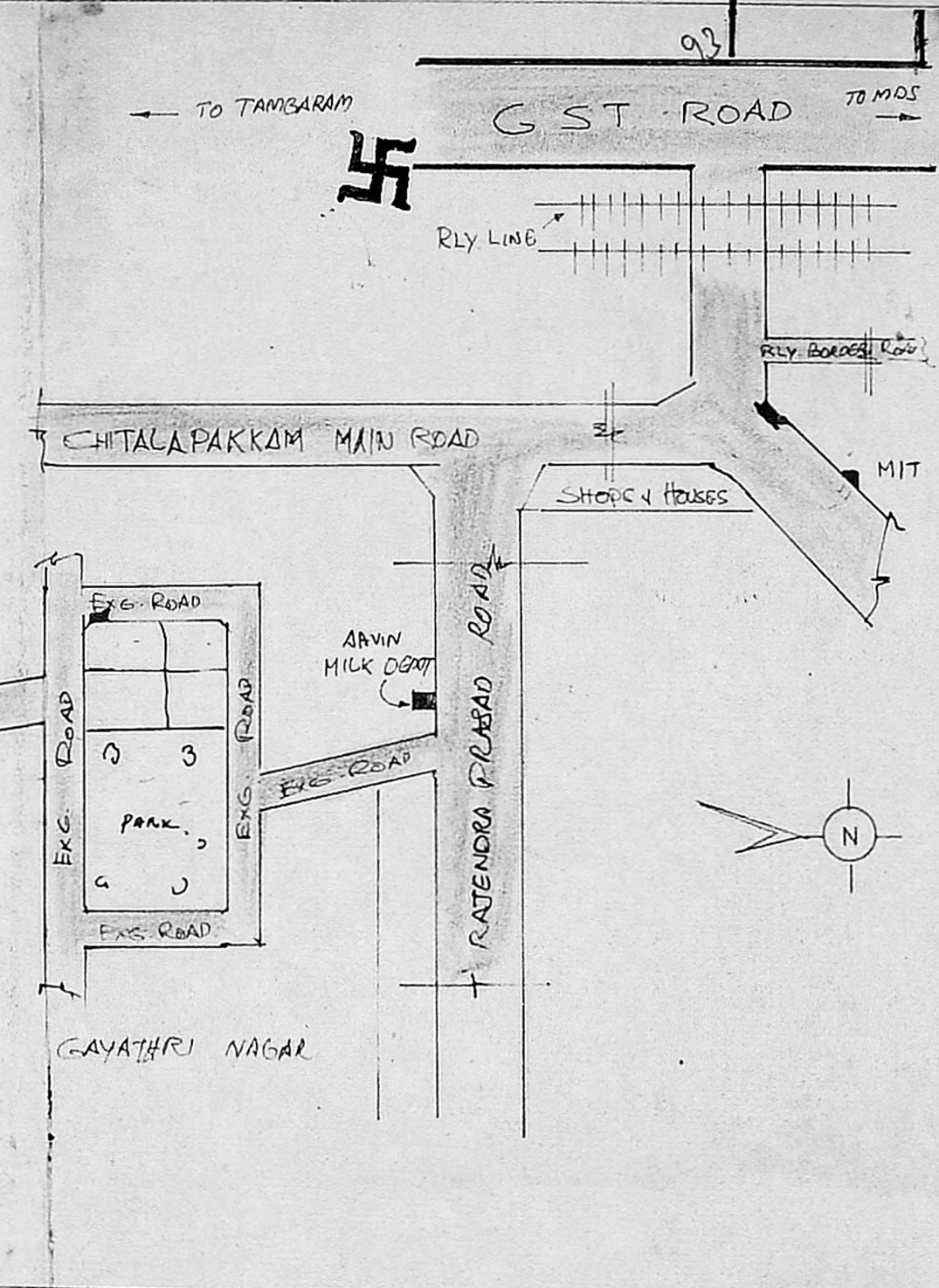
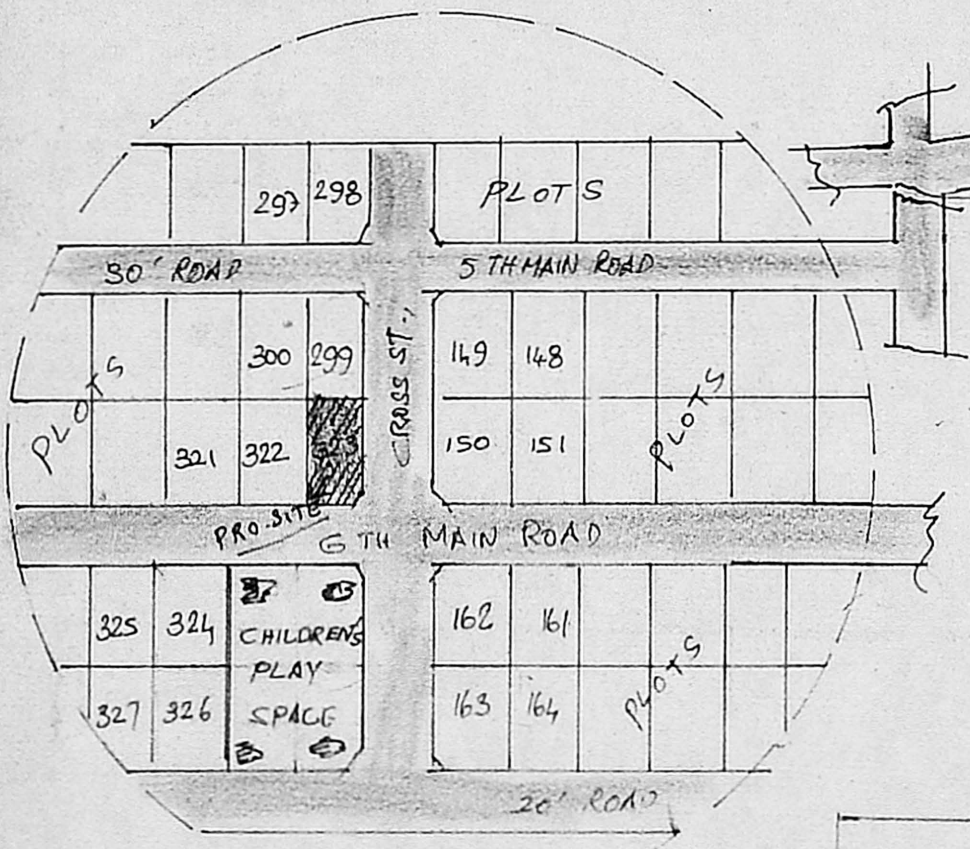

TOPO PLAN & KEY PLAN(nts)

**APPROVED**  
 WIDE LR. NO. L1/24844/92  
 DTD 10.92  
 P.P.D. NO. 145/92  
 L.O. NO. 86  
 2/11/92  
 FOR MEMBER SECRETARY  
 MADRAS METRO. DEV. AUTH.  
 DEVELOPMENT AUTH.

COLOUR INDEX			
PROPOSED	EXG.	ROAD	BOUNDRY
PLAN SHOWING THE REVISED SUB DIVISION			
PLAN IN P.No. 323 6 <sup>TH</sup> MAIN ROAD S.No. 45 & 47			
VENKAT RAMAN NAGAR HASTHINAPURAM VILLAGE			
CHROMEPET PALLAVAPURAM MUNICIPALITY SAIDAPET			
TALUK, CHENGAI M G R DIST. scale:-			
OWNER: Mr. B. CHANDRASEKARAN			
TOTAL PLOT AREA	323	3240 SFT	301.3 SMT
PLOT No 323 W/BUILDING	2000	2000 "	186.0 "
PLOT No 323A		1240 "	115.3 "
Jyotish Pathak <b>JYOTISH PATHAK, A.M.I.E.</b> CIVIL ENGINEER, LEO BUILDERS, 41A, Station Road I Floor, CHROMEPET, MADRAS-600 044.			
<b>B. Chandrasekaran</b> OWNER		L/S	

SUB - DIVISION & SITE PLAN

29/10/92  
 30/11/92